



Structure with a modern and linear design, entirely made with painted aluminum profiles and with pre-tensioned blackout PVC covers, or in embossed Valmex blackout PVC or in two-tone Opatex PVC, the structure is wall-mounted and moved by a radio-controlled electronic motor, which allows the folding opening of the fabric, up to maximum tension.

The pre-tensioned blackout PVC covers are available in the colors White, Gray and Vanilla; Valmex embossed blackout PVC covers are available in White, Ivory and Gray.

The cover is unique, with a particular antidrop and water channeling system, with the freestanding front gutter and the anti-drip gasket supplied as standard.

The structure is prepared for the installation of the lateral closing covers.

The M155 can cover underlying spaces up to 15 meters of Width and 8 meters of projection, alongside the maximum number of 3 MODULES, with a minimum footprint of the legs on the floor.

MINIMUM INCLINATION REQUIRED FOR CORRECT OPERATION 15%

OUR PERGOLAS ARE MADE WITH ROLLER TUBE AND ALUMINUM ACCESSORIES.

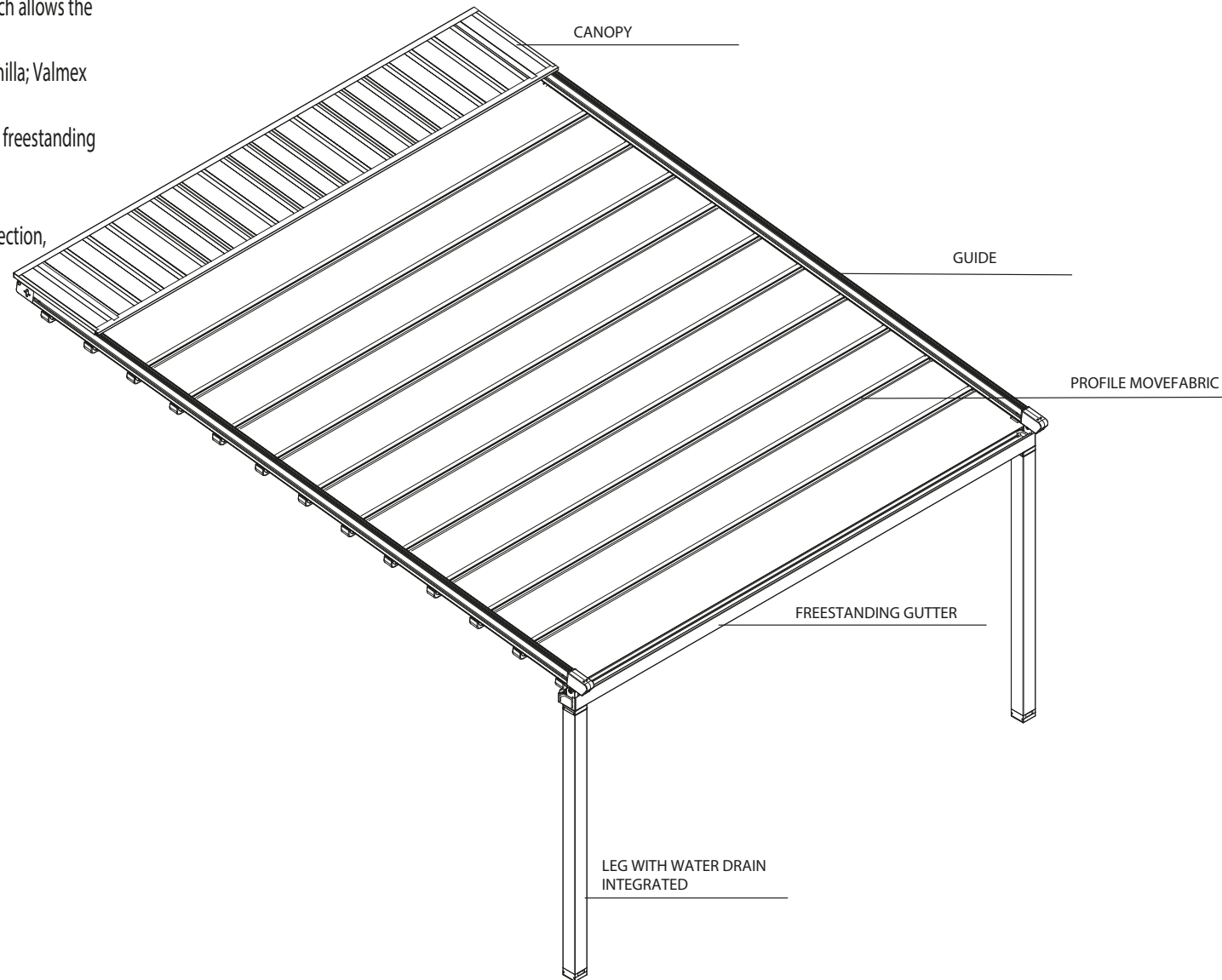

Maximum dimensions		
	width	projection
1 Module	500	800
2 Modules	1000	
3 Modules	1500	

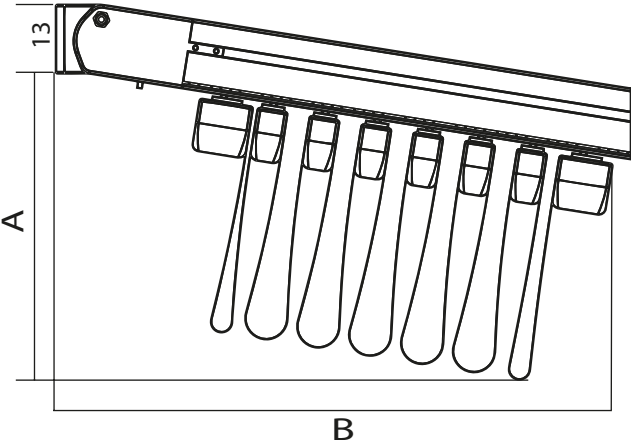

SP	A* CM	B* CM	P =
200	57	63	4
250	58	70	5
300	60	77	6
350	65	77	6
400	66	84	7
450	67	91	8
500	68	98	9
550	70	105	10
600	71	112	11
650	72	119	12
700	73	126	13
750	74	133	14
800	75	140	15

*VINDICATIVE VALUES

- SP** PROJECTION
A ENCUMBRANCE FABRIC IN HEIGHT (variable second inclination)
B ENCUMBRANCE FABRIC IN PROJECTION
P NUMBER OF PROFILES MOVEFABRIC (including terminal)

The distance between the profiles movefabric is never exceeding 60 cm.

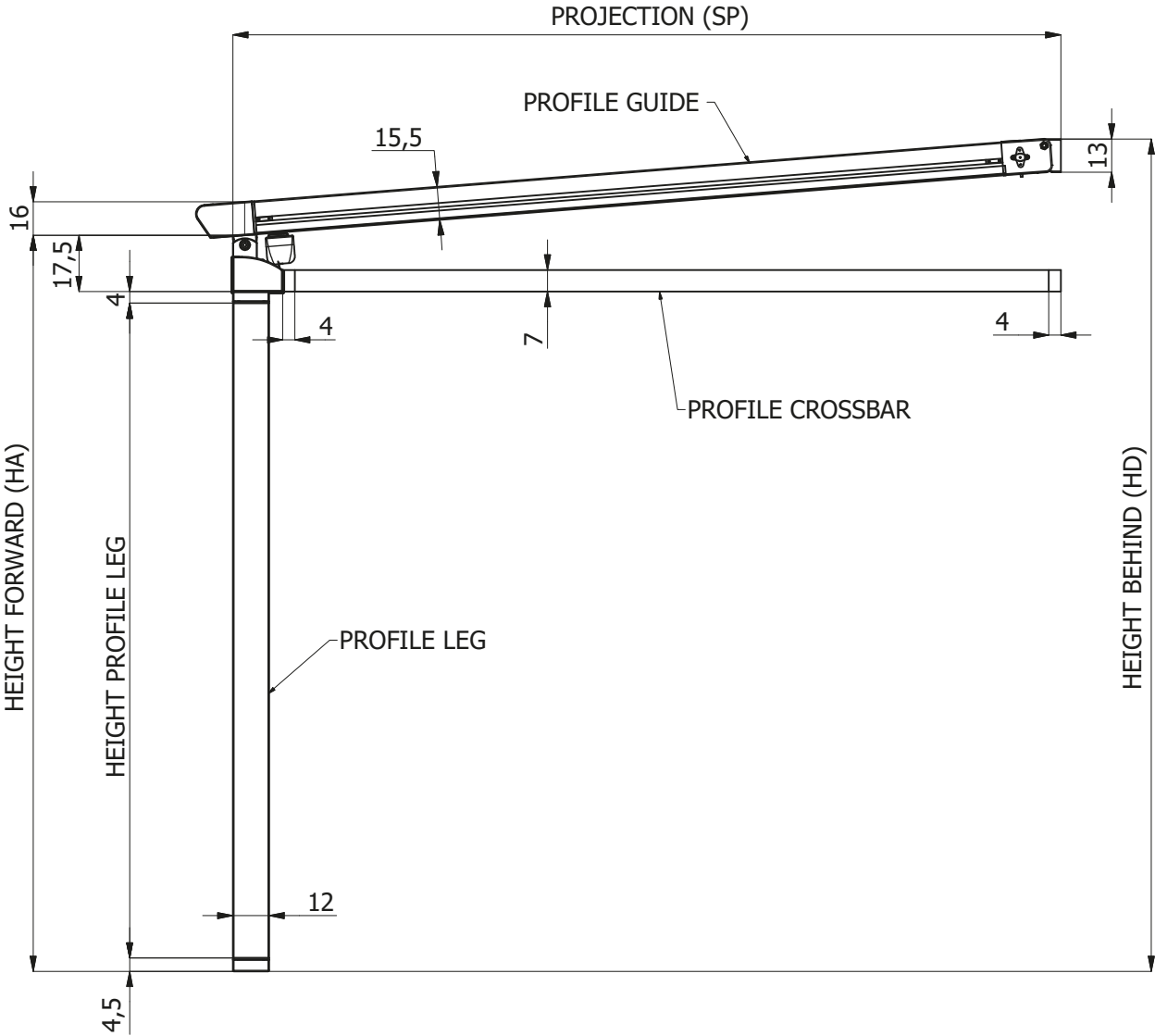



UNIVERSAL BRACKETS Wall Ceiling

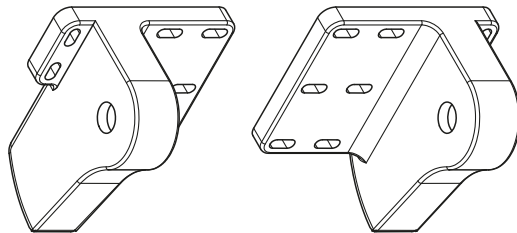
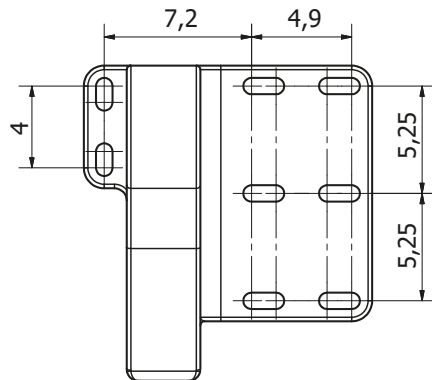

FOOT

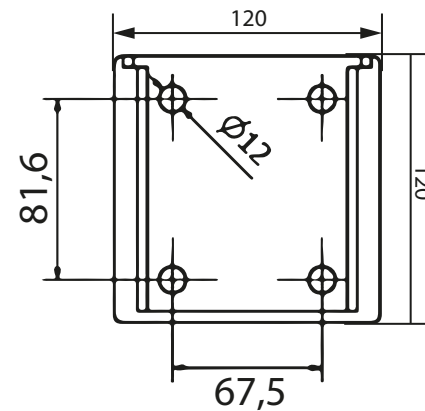

Detail of
water drain

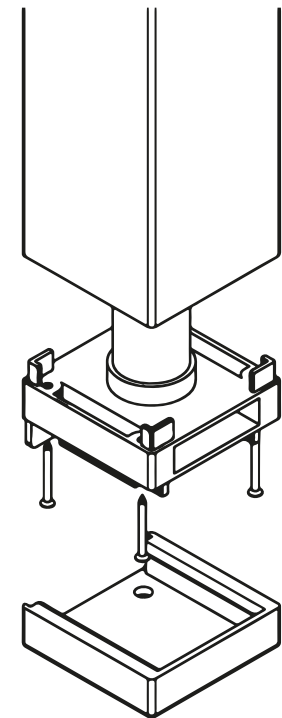
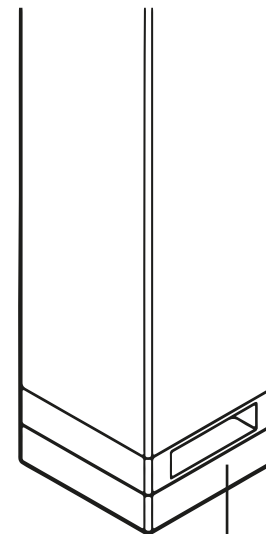

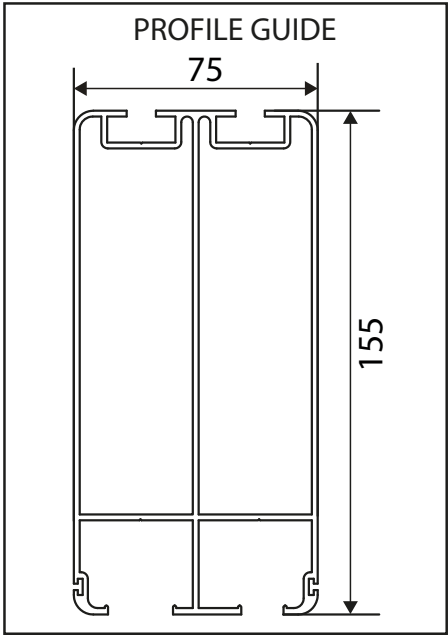
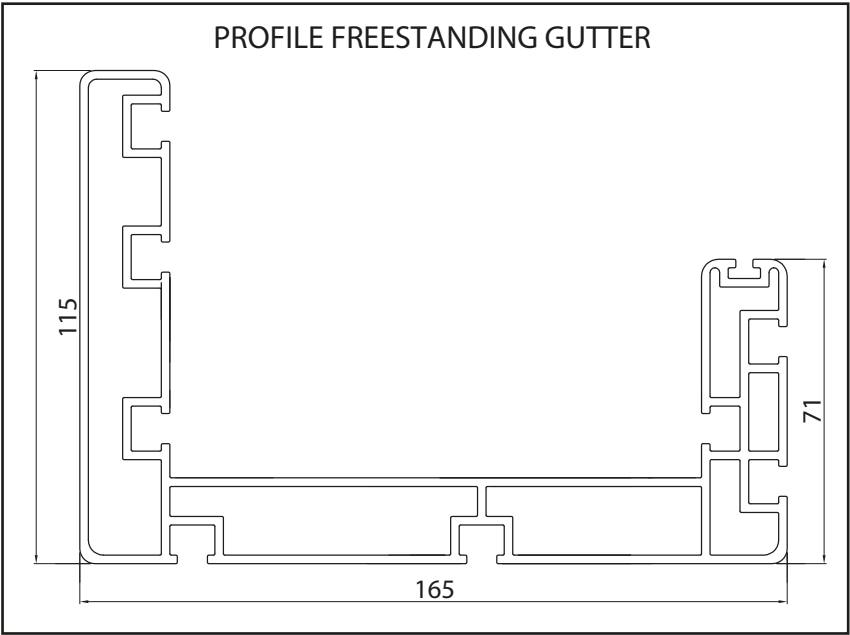
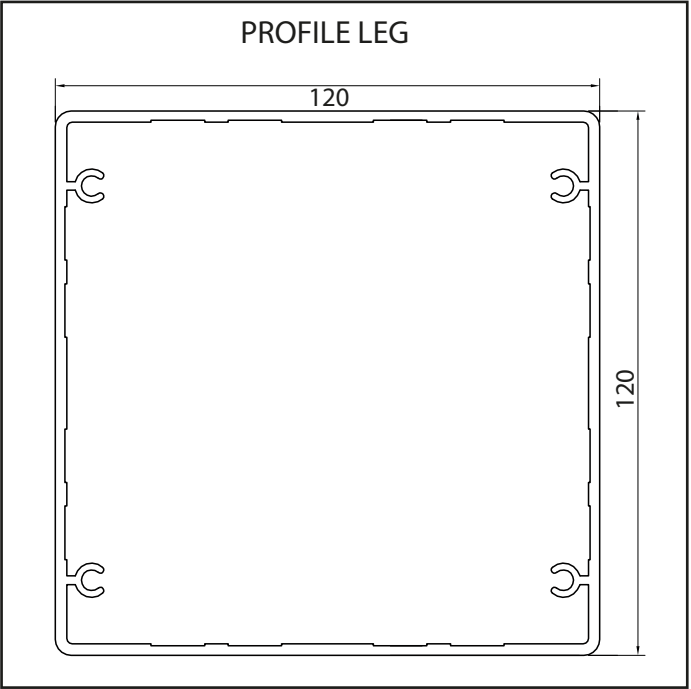
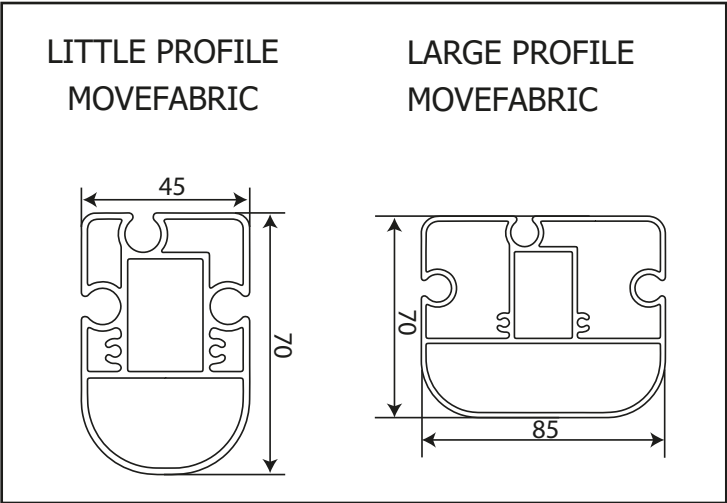



INSTALLATIONS

